

- DESIGNED AND MANUFACTURED TO OPSS 1821, APRIL 2013.
- AVAILABLE IN 9 STANDARD SIZES LISTED IN OPSS 1821.
- DRY CAST PRODUCTION PROCESS.
- SWIFT LIFT ANCHOR SYSTEM BY DAYTON/SUPERIOR OR EQ. EQV.
- TYLOX SUPERSEAL RUBBER GASKET BY HAMILTON KENT OR EQ. EQV.
- PRODUCED WITH WELDED WIRE REINFORCEMENT.
- INSTALLED WITH SPIGOT END DOWNSTREAM.
- STANDARD LAY LENGTH (L) = 2438.
- MIN LAY LENGTH (L) = 610.
- LAY LENGTH INTERVAL = 152.

**STANDARD UNIT**

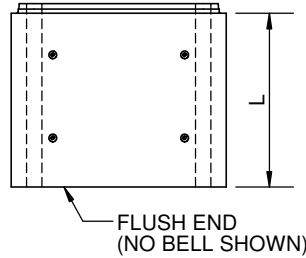
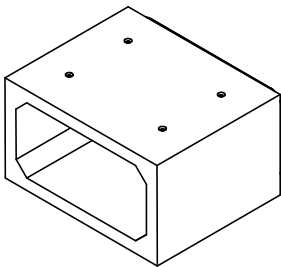

- FLUSH END AVAILABLE FOR BOTH BELL OR SPIGOT END.
- STANDARD LAY LENGTHS (L):
- = 2438 FOR FLUSH END, NO SPIGOT.
- = 2300 FOR FLUSH END, NO BELL.

**FLUSH END UNIT**

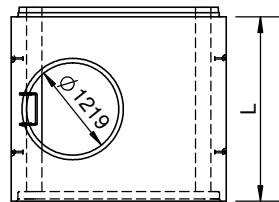
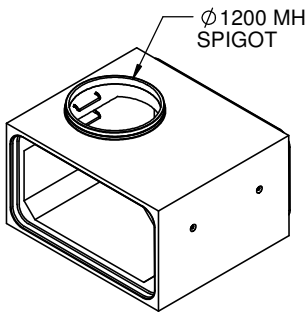

- MAINTENANCE HOLE TEE AS PER OPSD 707.010.
- ACCOMMODATE STANDARD 1200 mm DIA. MH COMPONENTS.
- STANDARD LAY LENGTH (L) = 2438.
- MANHOLE TEE RIGHT IS SHOWN
- MANHOLE TEE LEFT IS ALSO AVAILABLE

**MANHOLE TEE**

ALL DIMENSIONS ARE IN mm  
DRAWINGS ARE NOT TO SCALE

MIN. CONC STRENGTH 35 MPa  
CLEAR COVER = 40mm ± 5 mm  
TOLERANCES TO OPSS 1821

**CON CAST PIPE (CCP) STANDARD DRAWING**

STD. OPSS 1821

DOC ID BA-FIT

**PRECAST BOX UNITS  
END TREATMENTS  
AND FITTINGS**

1	SW RELEASE	KE	10/AUG/13
0	ORIGINAL RELEASE	PI	8/MAR/05
REV.	DESCRIPTION	ENG.	DATE

DRAWN BY KE	CHECKED BY SW	DATE 8/MAR/15	FILE BA FIT	PAGE 1 OF 4
----------------	------------------	------------------	----------------	----------------

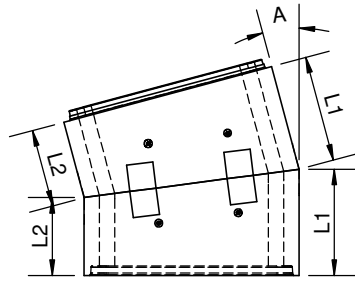
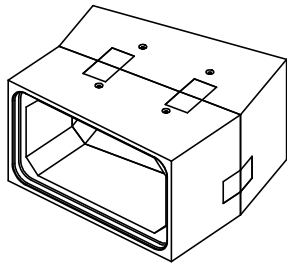

- TYPICAL DEFLECTION ANGLE (A) IN A SINGLE BOX UNIT IS FROM 15 UP TO 45 DEGREES.
- ACTUAL MAXIMUM DEFLECTION ANGLE DEPENDS ON SPAN
- LENGTHS  $L1 + L2 = 2438$ .
- FOR SMALLER DEFLECTION ANGLE THAN (A)  $<10^\circ$ , ALSO CONSIDER RADIUS BOX.

**BEND (EVEN)**

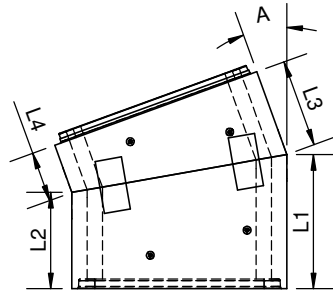
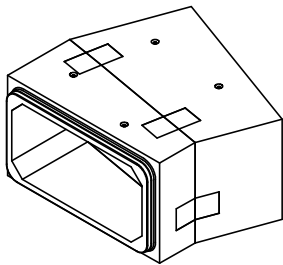

- UNEVEN BEND UNIT ACCOMODATES CULVERTS WITH MULTIPLE BEND POINTS
- LENGTHS  $L1 + L4 \leq 2438$  AND  $L2 + L3 \leq 2438$ .
- FOR SMALLER DEFLECTION ANGLE THAN (A)  $<10^\circ$ , ALSO CONSIDER RADIUS BOX.

**BEND (UNEVEN)**

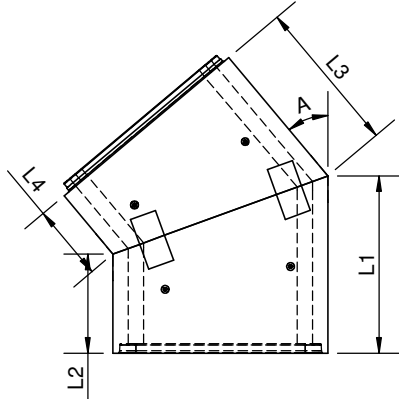
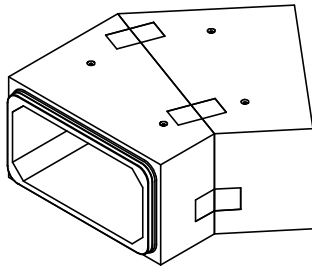

- EXTRA LONG BEND UNIT IS MADE FROM TWO STANDARD BOX UNITS FOR SPECIAL APPLICATIONS
- ACTUAL MAXIMUM DEFLECTION ANGLE DEPENDS ON SPAN
- LENGTHS  $L1, L3 \leq 2438$
- FOR SMALLER DEFLECTION ANGLE THAN (A)  $<10^\circ$ , ALSO CONSIDER RADIUS BOX.

**BEND (EXTRA LONG)**

ALL DIMENSIONS ARE IN mm  
DRAWINGS ARE NOT TO SCALE

MIN. CONC STRENGTH 35 MPa  
CLEAR COVER =  $40\text{mm} \pm 5\text{ mm}$   
TOLERANCES TO OPSS 1821

**CON CAST PIPE (CCP) STANDARD DRAWING**

STD. OPSS 1821

DOC ID BA-FIT

**PRECAST BOX UNITS  
END TREATMENTS  
AND FITTINGS**

1	SW RELEASE	KE	10/AUG/15
0	ORIGINAL RELEASE	PI	8/MAR/PI
REV.	DESCRIPTION	ENG.	DATE

DRAWN BY KE	CHECKED BY SW	DATE 8/MAR/15	FILE BA FIT	PAGE 2 OF 4
----------------	------------------	------------------	----------------	----------------

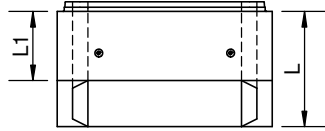
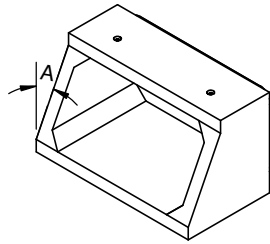

- SLOPED END AVAILABLE FOR BOTH BELL OR SPIGOT END.
- DIMENSION 'L1' SHOULD NOT BE LESS THAN 610.
- STANDARD LAY LENGTH (L) = 2438 WITH SPIGOT.  
(L) = 2300 WITH BELL.
- MAXIMUM SLOPE (A) DEPENDS ON RISE  
GIVEN L1 = 610 IS MAINTAINED

**SLOPED END (STYLE 1)**

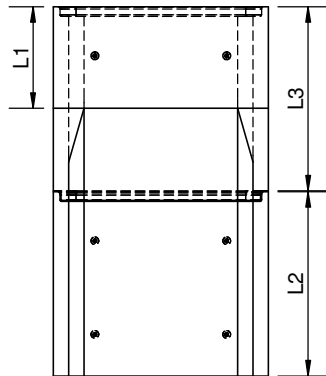
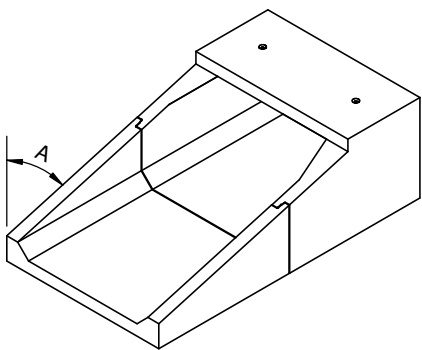

- SLOPED END AVAILABLE FOR BOTH BELL OR SPIGOT END.
- DIMENSION 'L1' SHOULD NOT BE LESS THAN 610.
- LAY LENGTH (L2) = 2438 WITH SPIGOT.  
2300 WITH BELL.  
(L3) = 2438 MAX.
- MAXIMUM SLOPE (A) DEPENDS ON RISE  
GIVEN L1 = 610 IS MAINTAINED

**SLOPED END (STYLE 2)**

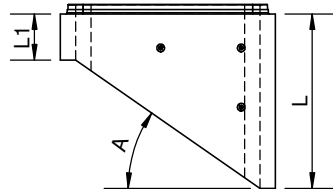
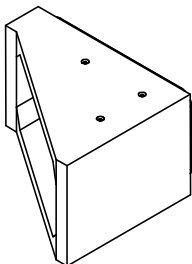

- BEVELLED END AVAILABLE FOR BOTH BELL OR SPIGOT END.
- DIMENSION 'L1' SHOULD NOT BE LESS THAN 610.
- STANDARD LAY LENGTH (L) = 2438 WITH SPIGOT.  
(L) = 2300 WITH BELL.
- MAXIMUM SLOPE (A) DEPENDS ON RUN  
GIVEN L1 = 610 IS MAINTAINED

**BEVELLED END**

ALL DIMENSIONS ARE IN mm  
DRAWINGS ARE NOT TO SCALE

MIN. CONC STRENGTH 35 MPa  
CLEAR COVER = 40mm ± 5 mm  
TOLERANCES TO OPSS 1821

**CON CAST PIPE (CCP) STANDARD DRAWING**

STD. OPSS 1821

DOC ID BA-FIT

**PRECAST BOX UNITS  
END TREATMENTS  
AND FITTINGS**

1	SW RELEASE	KE	10/AUG/15
0	ORIGINAL RELEASE	PI	8/MAR/05
REV.	DESCRIPTION	ENG.	DATE

DRAWN BY KE	CHECKED BY SW	DATE 8/MAR/15	FILE BA FIT	PAGE 3 OF 4
----------------	------------------	------------------	----------------	----------------

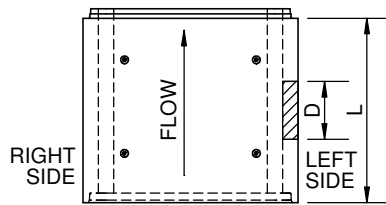
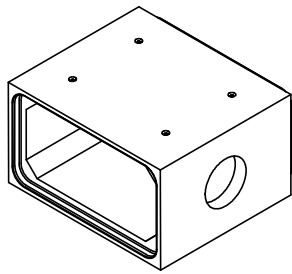

- LEFT OR RIGHT SIDE IS REFERENCED LOOKING UPSTREAM.
- STANDARD LAY LENGTH (L) = 2438
- MAXIMUM HOLE DIAMETER (D) = RISE OF BOX OR 1/2 L WHICH EVER IS SMALLER

**SCRIBED OR CORED HOLE**

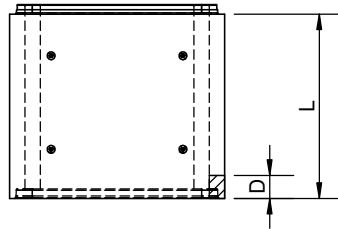
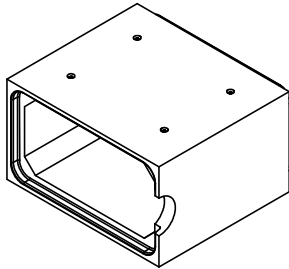

- STANDARD LAY LENGTH (L) = 2438
- MAXIMUM HOLE DIAMETER (D) = RISE OF BOX OR (L) WHICH EVER IS SMALLER

**SCRIBED OR CORED PARTIAL HOLE**

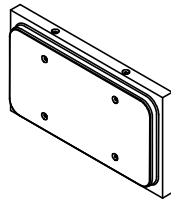
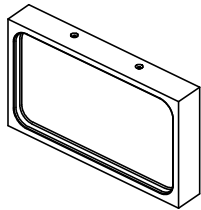

- CAP INSTALLED ON SPIGOT END OF BOX UNIT.
- PLUG INSTALLED ON BELL END OF BOX UNIT (INCL. GASKET).
- MIN. THICKNESS = 300 mm.
- CAP/PLUG STYLE TRANSITION TO SMALLER CIRCULAR, ELLIPTICAL, OR BOX UNIT AVAILABLE.
- CAP AND PLUG MADE OF WET CAST CONCRETE.

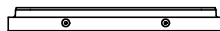
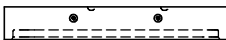

**CAP**

**PLUG**

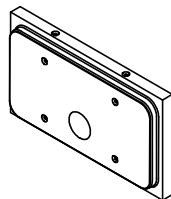
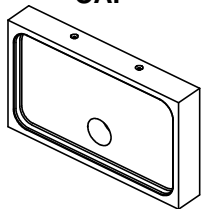

- CAP INSTALLED ON SPIGOT END OF BOX UNIT.
- PLUG INSTALLED ON BELL END OF BOX UNIT (INCL. GASKET).
- MIN. THICKNESS = 300 mm.
- CAP/PLUG STYLE TRANSITION TO SMALLER CIRCULAR, ELLIPTICAL, OR BOX UNIT AVAILABLE.

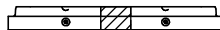

**CAP WITH HOLE**

**PLUG WITH HOLE**

ALL DIMENSIONS ARE IN mm  
DRAWINGS ARE NOT TO SCALE

TOLERANCES TO OPSS 1821

**CON CAST PIPE (CCP) STANDARD DRAWING**

STD. OPSS 1821

DOC ID BA-FIT

**PRECAST BOX UNITS  
END TREATMENTS  
AND FITTINGS**

1	SW RELEASE	KE	10/AUG/15
0	ORIGINAL RELEASE	PI	8/MAR/05
REV.	DESCRIPTION	ENG.	DATE

DRAWN BY KE	CHECKED BY SW	DATE 8/MAR/15	FILE BA FIT	PAGE 4 OF 4
----------------	------------------	------------------	----------------	----------------