

FRONT VIEW

TYPE B

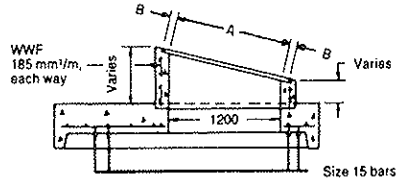

SECTION A-A

SLOPE OF GRATING	DIMENSIONS	
	A	B
2 : 1	1365	55
3 : 1	1285	95
4 : 1	1260	110
6 : 1	1240	55
8 : 1	1230	60
10 : 1	1225	60
Horizontal	1220	65

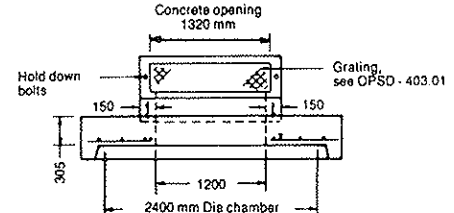

FRONT VIEW

TYPE A

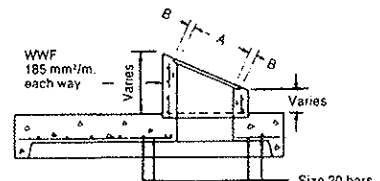

SECTION B-B

SLOPE OF GRATING	DIMENSIONS	
	A	B
2 : 1	675	50
3 : 1	645	65
4 : 1	625	75

- NOTES:**
- A All reinforcing steel shall have 25 mm min cover.
 - B Weep holes, where required, shall be placed so that the bottom of the weeper on the inside and the top of the weeper on the outside are level.
 - C All dimensions are in millimetres unless otherwise specified.

CONCAST
 R.R. #3, Guelph, Ontario N1H 6H9
 Tel: 1-800-668-PIPE (7473)

CON CAST PIPE | No. 706.03

600 x 1200 mm
PRECAST CONCRETE
DITCH INLET MAINTENANCE HOLES
WITH 2400 mm Dia. FLAT CAP